

Features and Benefits

- Thermoplastic design eliminates process and atmospheric corrosion.
- Pressure rated up to 150 psi, non-shock water at 73° F.
- Socket dimensions meet all ASTM requirements.
PVC: D-2467, D-2464
- Bi-directional: can be installed in either direction.
- Replacement handle kits available.
- NSF – 61 Approved for Potable Water Service



MIP Compact Valves answer the need for an economically priced compact quarter turn ball valve for use in irrigation, water treatment, pool/spa, and commercial plumbing applications. Available in 1/2 - 4" sizes



COMMERCIAL MIP (MOLDED IN PLACE) COMPACT VALVE



Revised 11/09

Size	White Socket	White Threaded	Gray Socket	Gray Threaded
1/2	V07491N	V07591N	V07691N	V07791N
3/4	V08491N	V08591N	V08691N	V08791N
1	V10491N	V10591N	V10691N	V10791N
1-1/4	V14491N	V14591N	V14691N	V14791N
1-1/2	V17491N	V17591N	V17691N	V17791N
2	V20491N	V20591N	V20691N	V20791N
2-1/2	V27491N	V27591N		
3	V30491N	V30591N		
4	V40491N	V40591N		

Pressure rated up to 150 psi,
non-shock water at 73° F.

Temp (°F)	PVC
73	1.00
80	.88
90	.75
100	.62
110	.50
120	.40
130	.30
140	.22
150	NR
160	NR

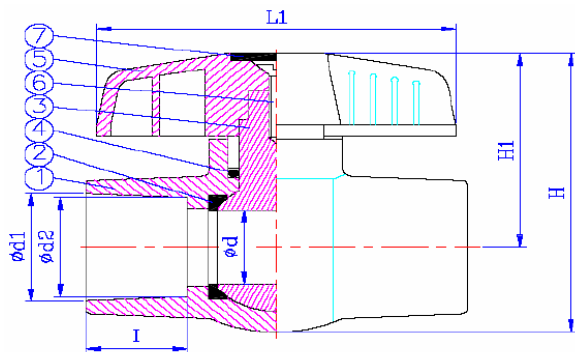
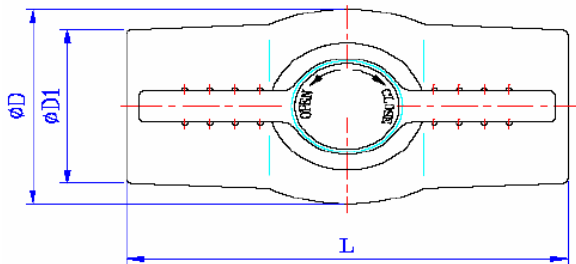

NO.	Part	Material	Quantity
1	Body	PVC	1
2	Seat Seal	EPDM	2
3	Ball	PVC	1
4	O-ring	EPDM	1
5	Handle	ABS	1
6	Bolt	Zinc-Plated Steel	1
7	Cap	ABS	1

	1/2"	3/4"	1"	1-1/4"	1-1/2"	2	2-1/2"	3"	4"
d1	7/8	1-1/16	1-5/16	1-11/16	1-15/16	2-3/8	2-7/8	3-1/2	4-1/2
d2	13/16	1-1/16	1-5/16	1-10/16	1-7/8	2-3/8	2-7/8	3-1/2	4-1/2
l	7/8	1	1-1/8	1-1/4	1-3/8	1-1/2	1-3/4	1-7/8	2-1/4
D	1-1/2	1-7/8	2	2-1/2	3	3-5/8	4-5/16	5-1/4	6-11/16
D1	1-1/8	1-1/2	1-3/4	2-1/8	2-1/2	3	3-5/8	4-3/16	4
d	1/2	3/4	1	1-1/8	1-3/8	1-7/8	2-3/8	3-1/16	4
L	3-1/4	3-3/4	4-1/8	4-1/2	5-1/8	5-3/4	8-1/16	9	11-13/16
L1	2-3/4	3-1/2	3-7/8	3-7/8	4-1/2	5-1/2	7	8-13/16	10-7/8
H	2-1/2	3-1/8	3-5/8	3-7/8	4-1/2	5-3/8	6-5/16	7-1/2	9-3/16
H1	1-3/4	2-1/8	2-1/2	2-5/8	3-1/8	3-1/2	4-1/8	4-7/8	5-13/16



CUSTOMER SERVICE: 6400 Corporate Ave., Portage, MI 49002
Toll-free (800)374 0234, Phone (269)323 2495, Fax (269) 323 0630 www.colonialengineering.com